

# Milchwerk

RADOLFZELL

TAGUNG : KULTUR : MESSE

Raum **TG 6**

Reihenbestuhlung  
49 Pax + 2 Referenten  
Zeichner: C.L.  
Genehmigt:  
Datum:

229,0  
200,0

STUK = 200,0

TG 6 49 m<sup>2</sup>

1.20

50

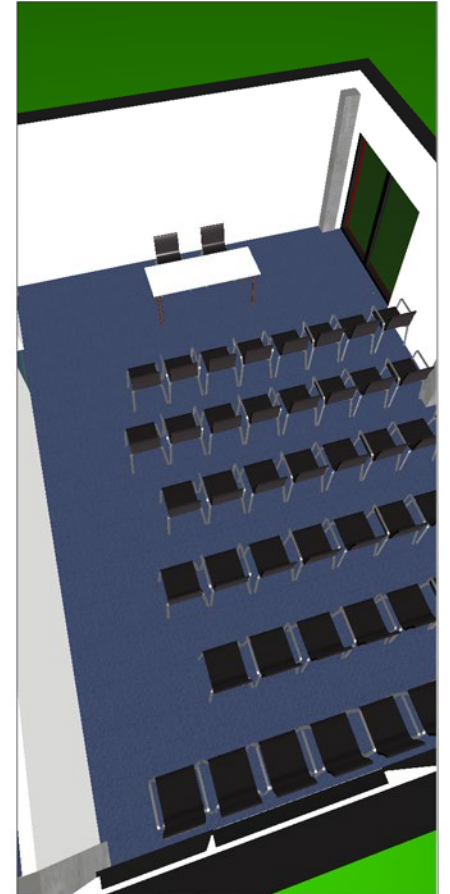

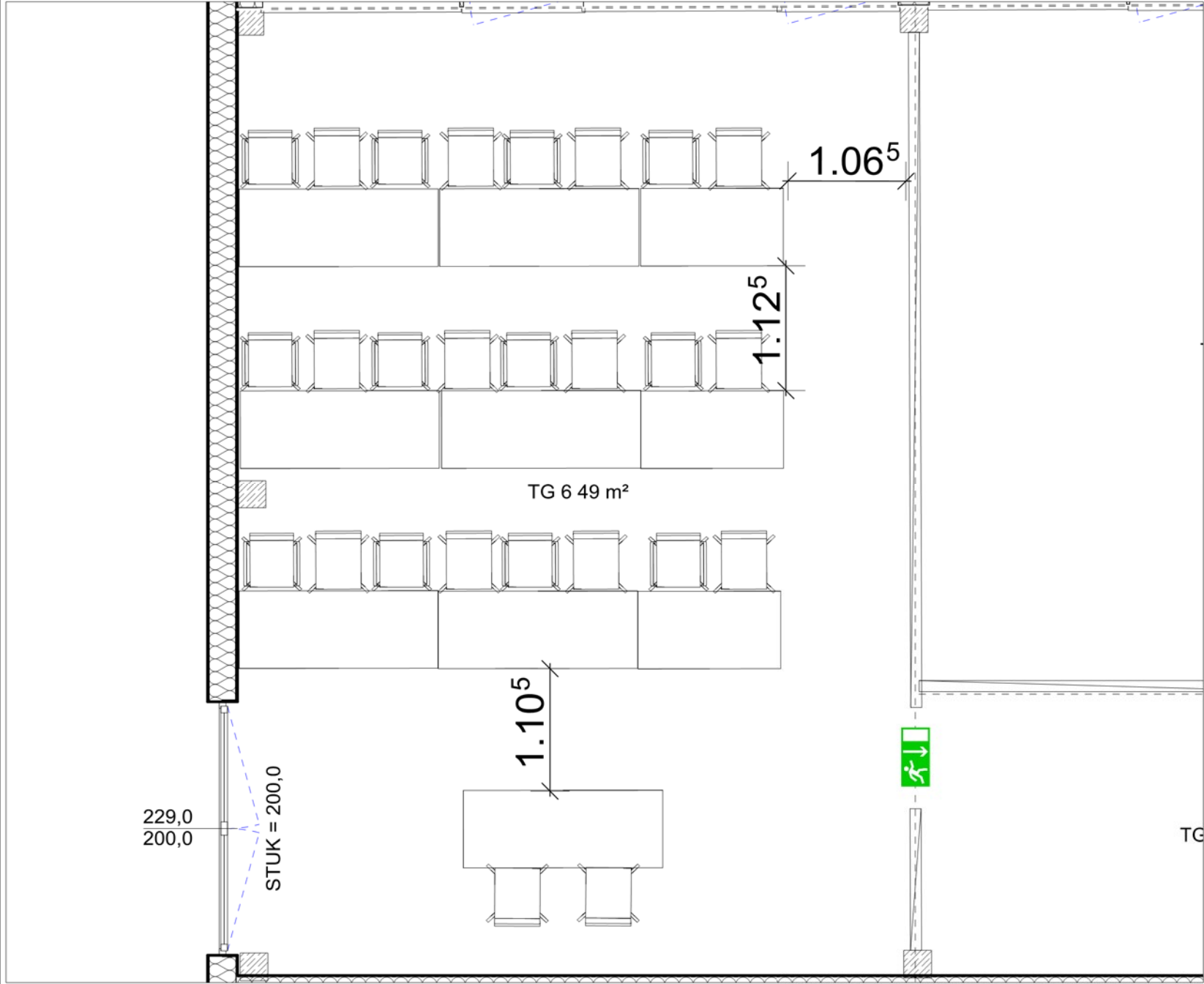

**Milchwerk**  
RADOLFZELL

TAGUNG : KULTUR : MESSE

Raum **TG 6**

Parlamentarische Bestuhlung  
24 Pax + 2 Referenten  
Zeichner: C.L.  
Genehmigt:  
Datum:

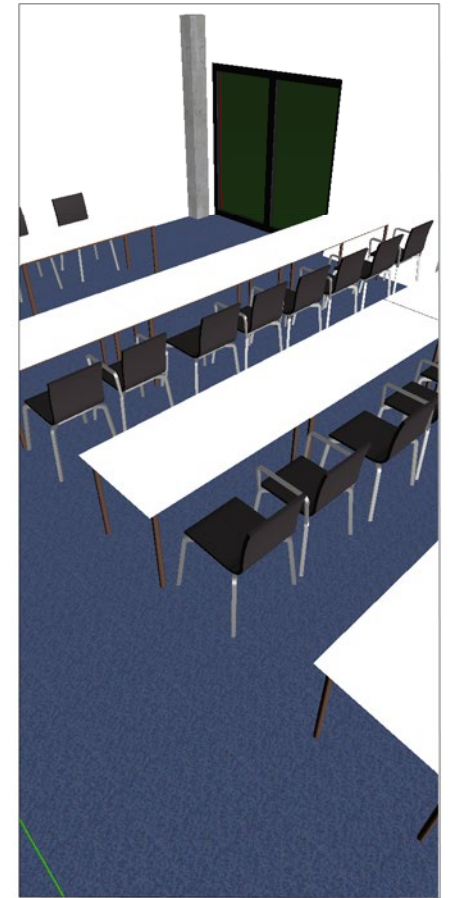

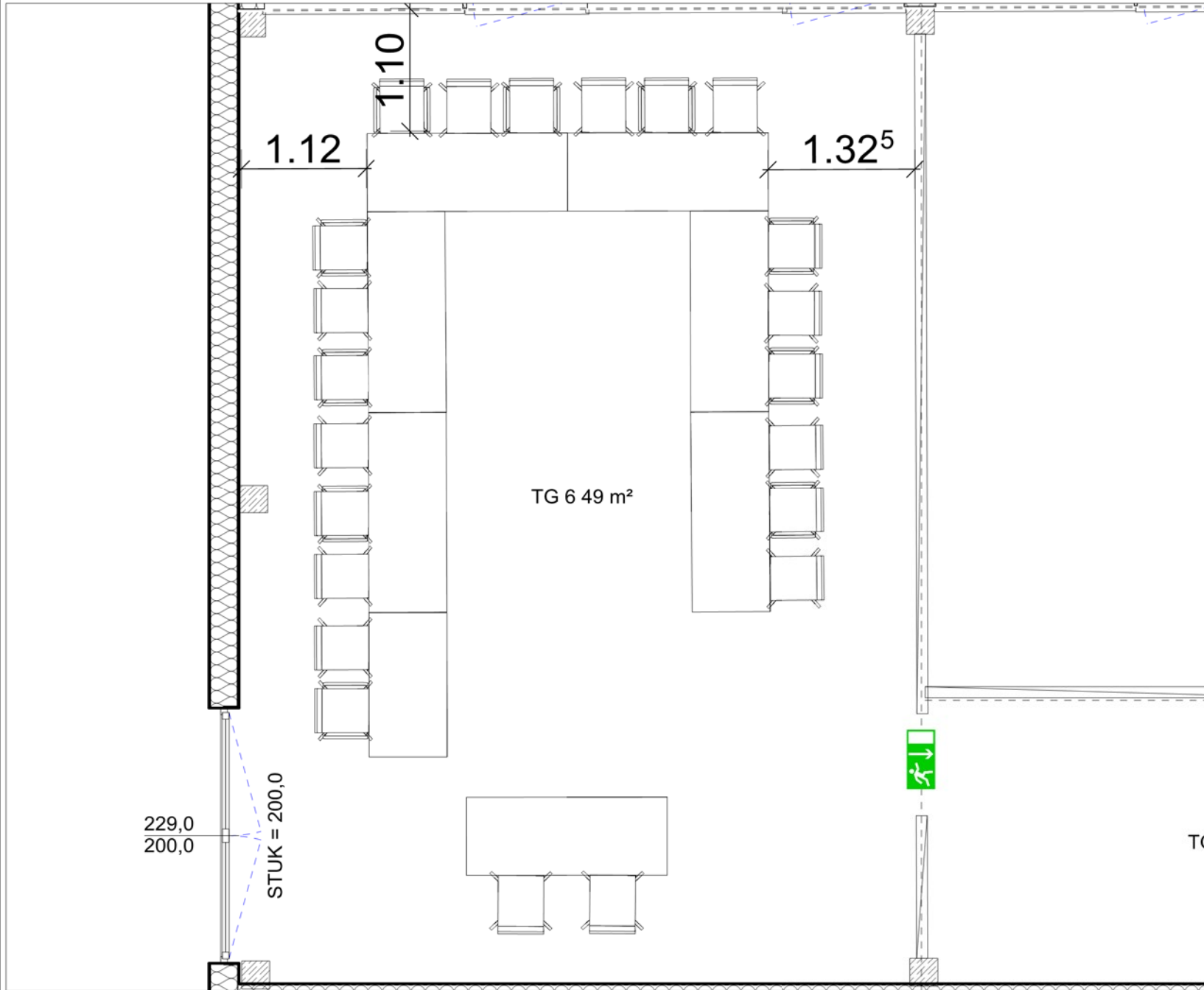

**Milchwerk**  
RADOLFZELL

TAGUNG : KULTUR : MESSE

Raum **TG 6**

U Bestuhlung  
20 Pax + 2 Referenten  
Zeichner: C.L.  
Genehmigt:  
Datum:

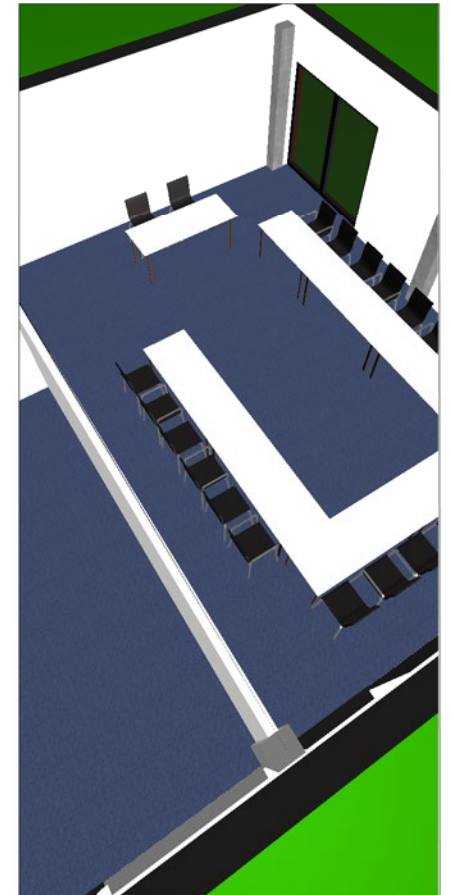

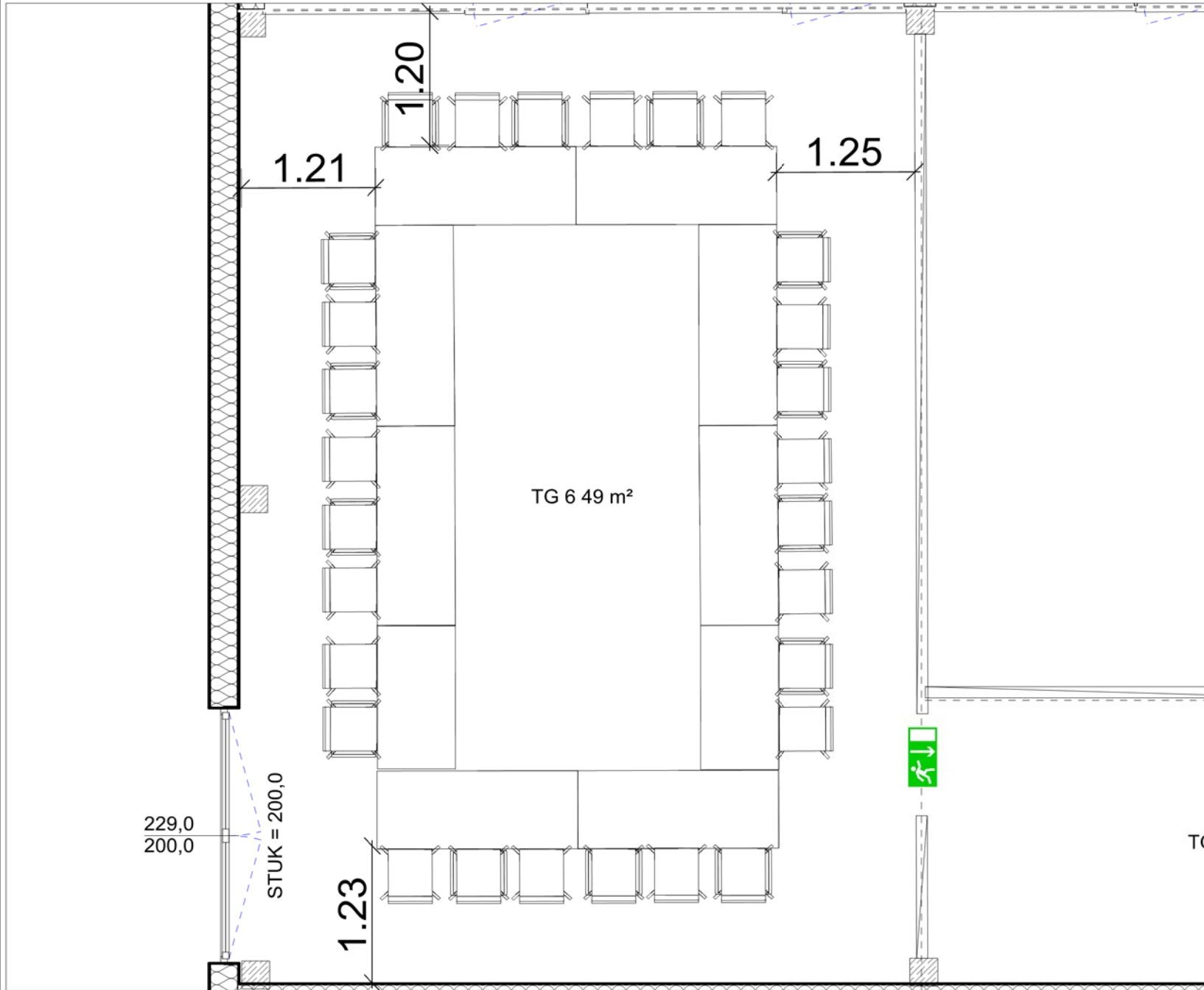

Milchwerk  
RADOLFZELL

TAGUNG : KULTUR : MESSE

Raum  
**TG 6**

Carré  
28 Pax  
Zeichner: C.L.  
Genehmigt:  
Datum:

