

Milchwerk

RADOLFZELL

TAGUNG : KULTUR : MESSE

Raum **TG 3**

Reihenbestuhlung
142 Pax + 2 Referenten
Zeichner: C.L.
Genehmigt:
Datum:

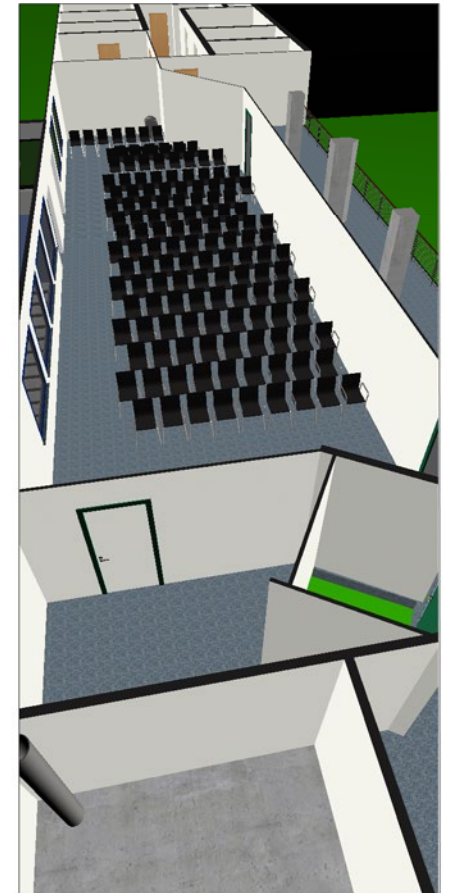
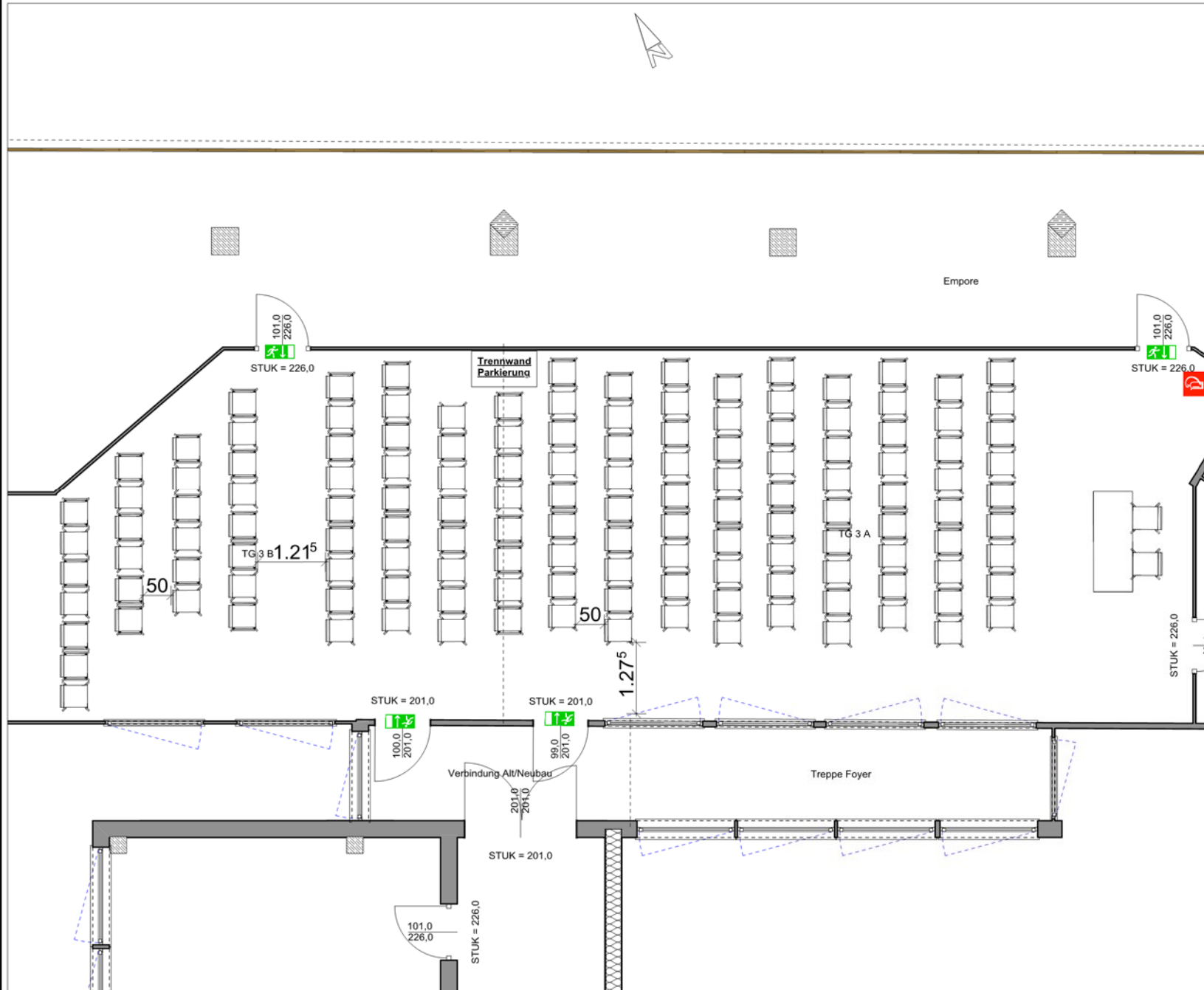

Milchwerk

RADOLFZELL

TAGUNG : KULTUR : MESSE

Raum **TG 3**

Parlamentarische Bestuhlung
71 Pax + 2 Referenten

Zeichner: C.L.
Genehmigt:
Datum:

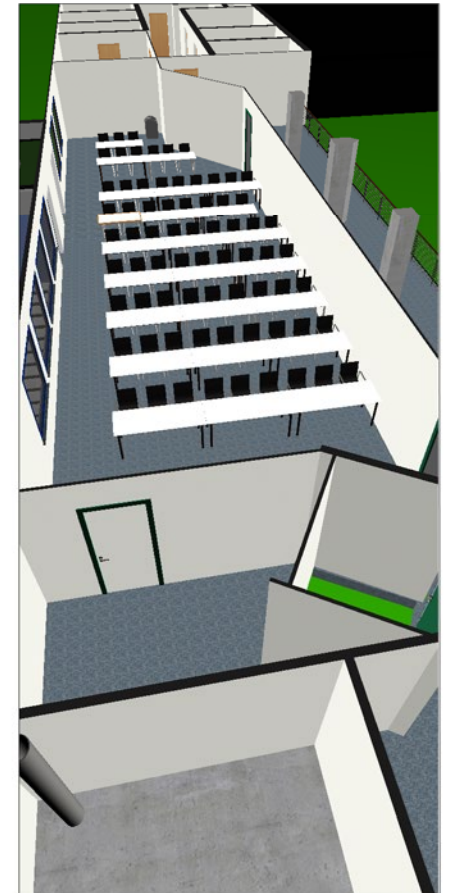
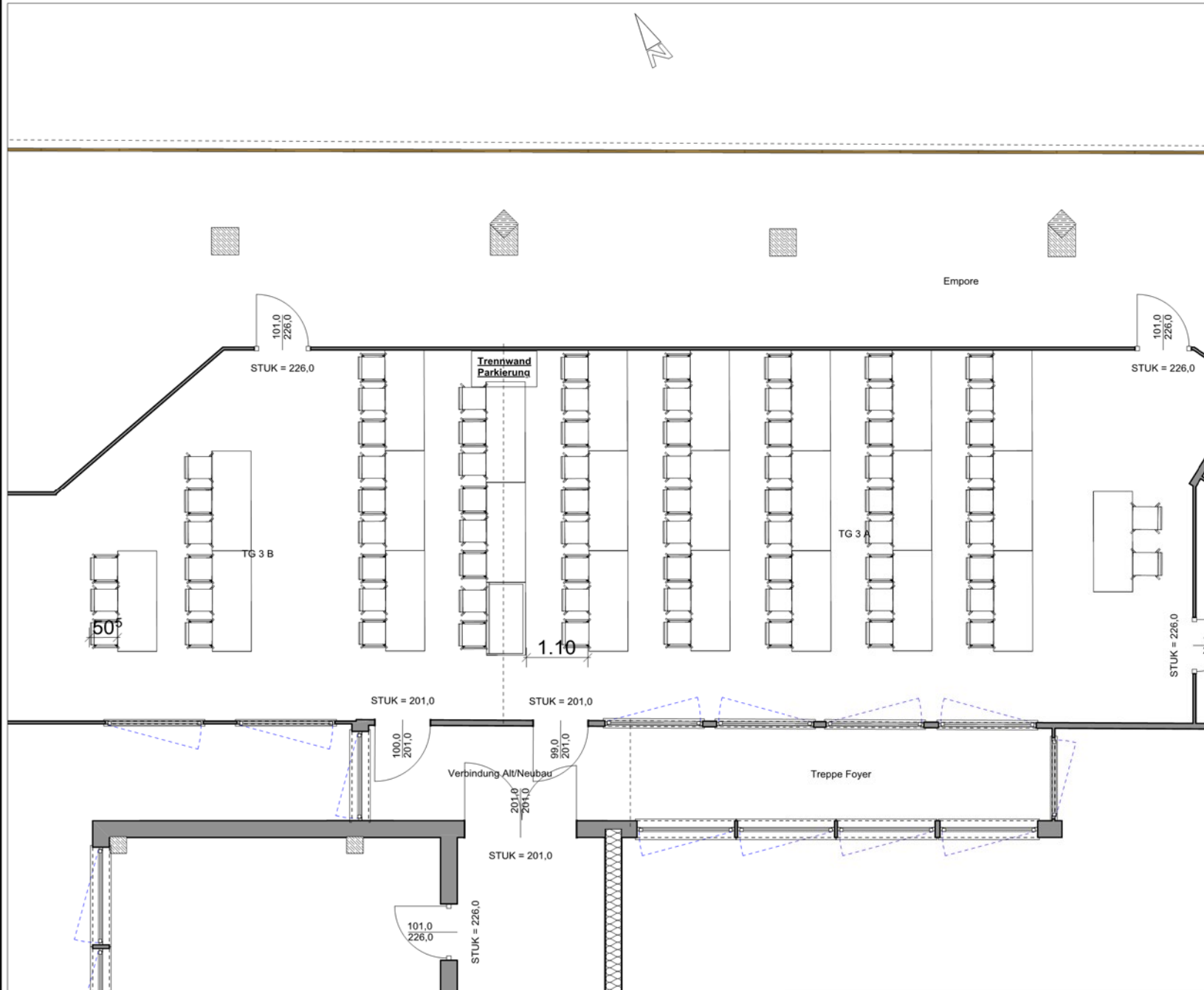

Milchwerk

RADOLFZELL

TAGUNG : KULTUR : MESSE

Raum **TG 3**

U Bestuhlung
48 Pax + 2 Referenten
Zechner: C.L.
Genehmigt:
Datum:

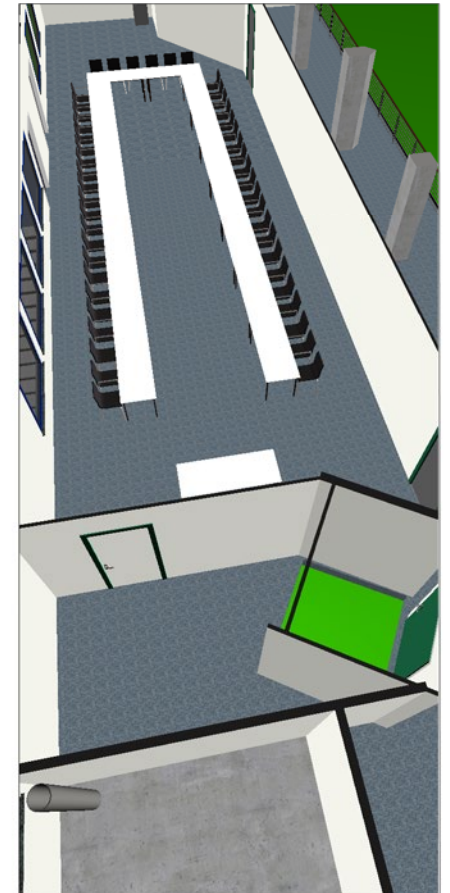
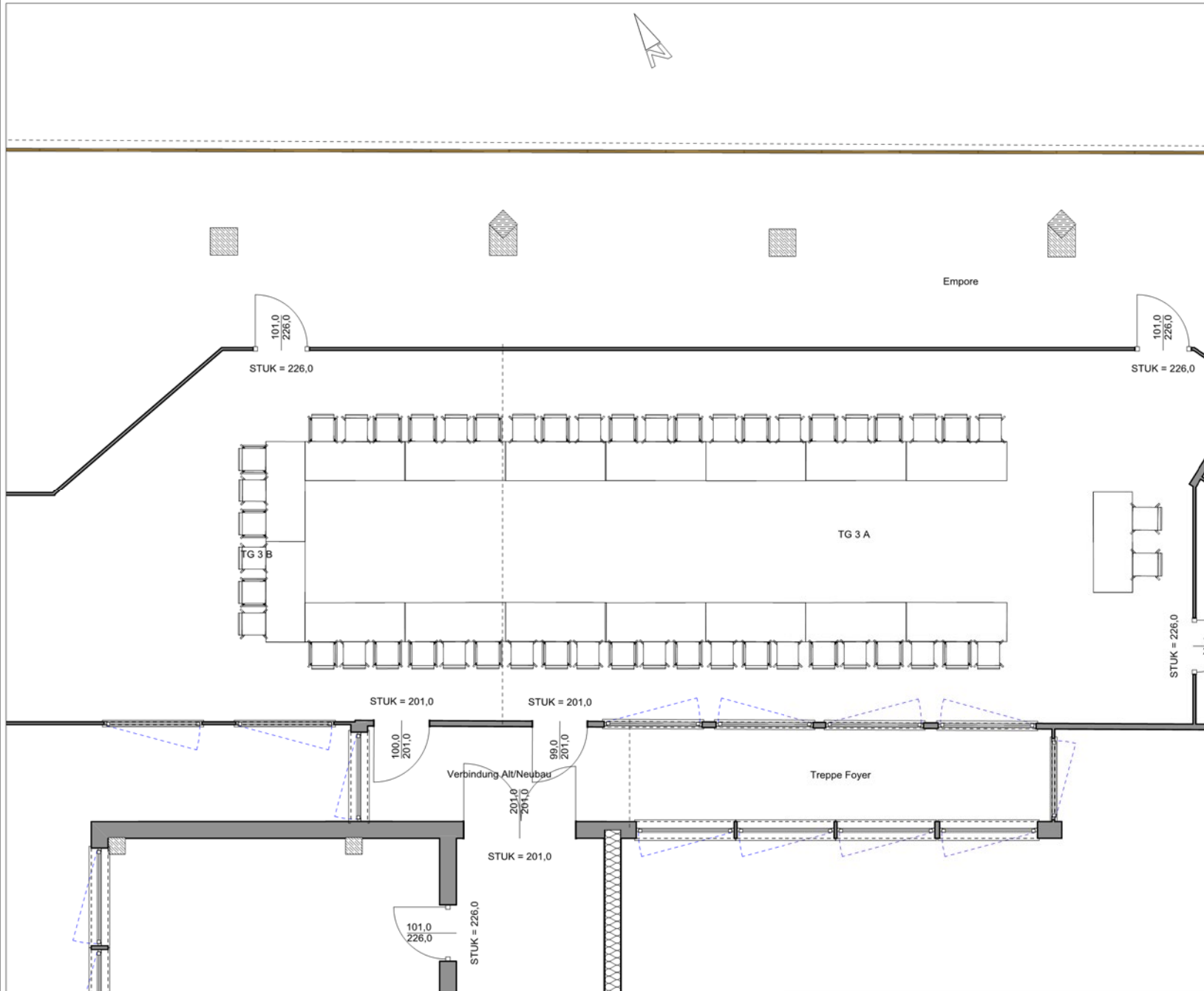

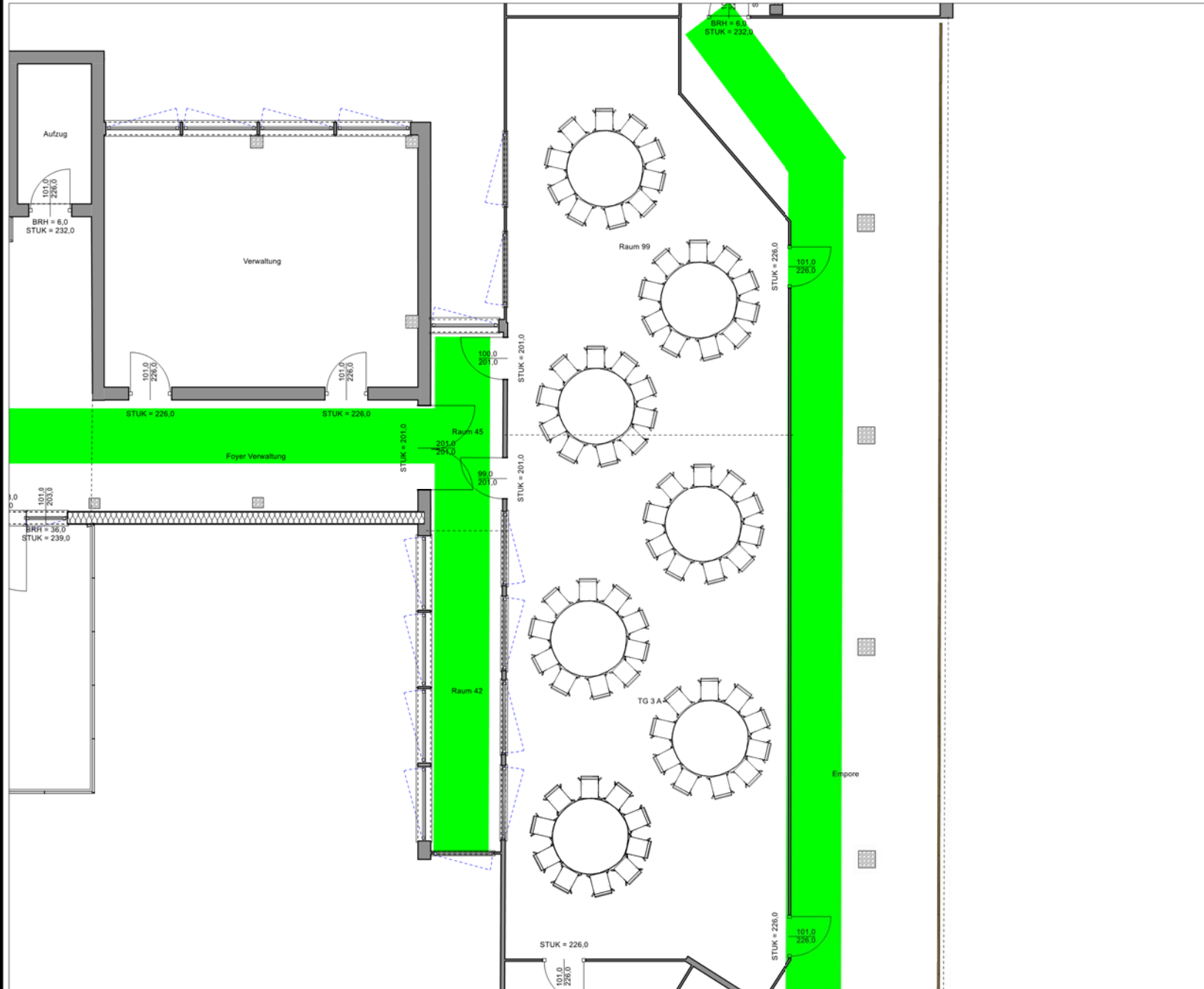

Milchwerk

RADOLFZELL

TAGUNG : KULTUR : MESSE

Raum **TG 3**

Bankett Rund
70 Pax
Zeichner: C.L.
Genehmigt:
Datum:

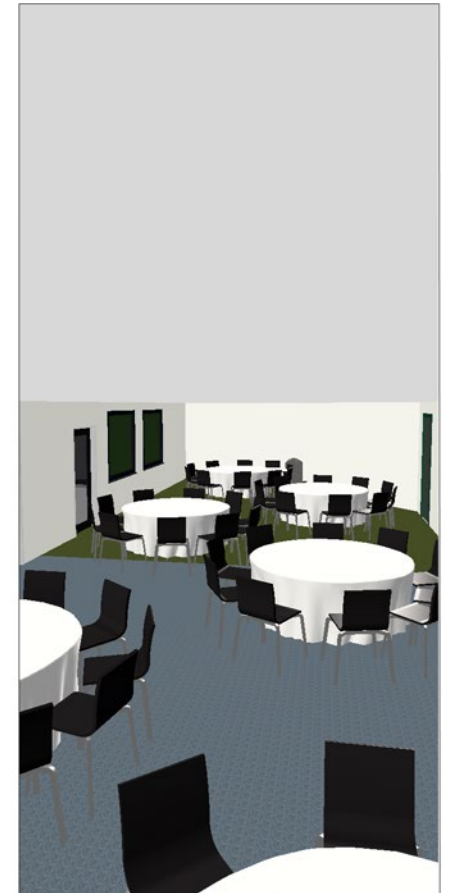

Milchwerk

RADOLFZELL

TAGUNG : KULTUR : MESSE

Raum **TG 3**

Blockbankett
40 Pax + 6 Referenten
Zeichner: C.L.
Genehmigt:
Datum:

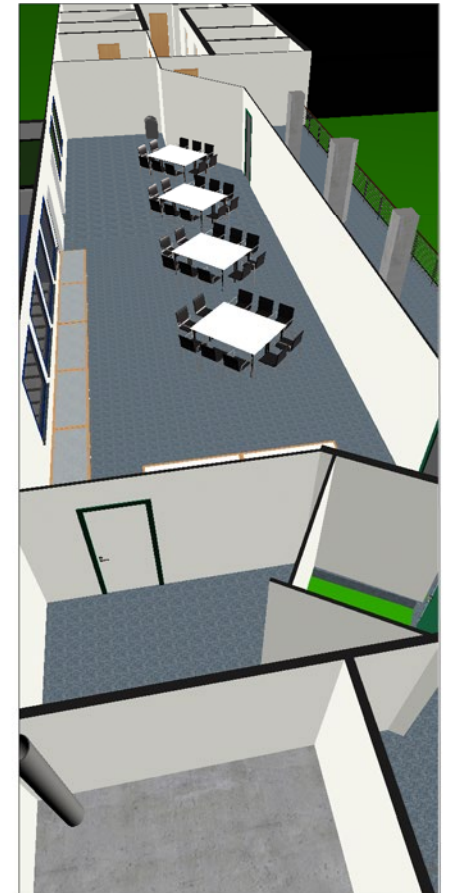
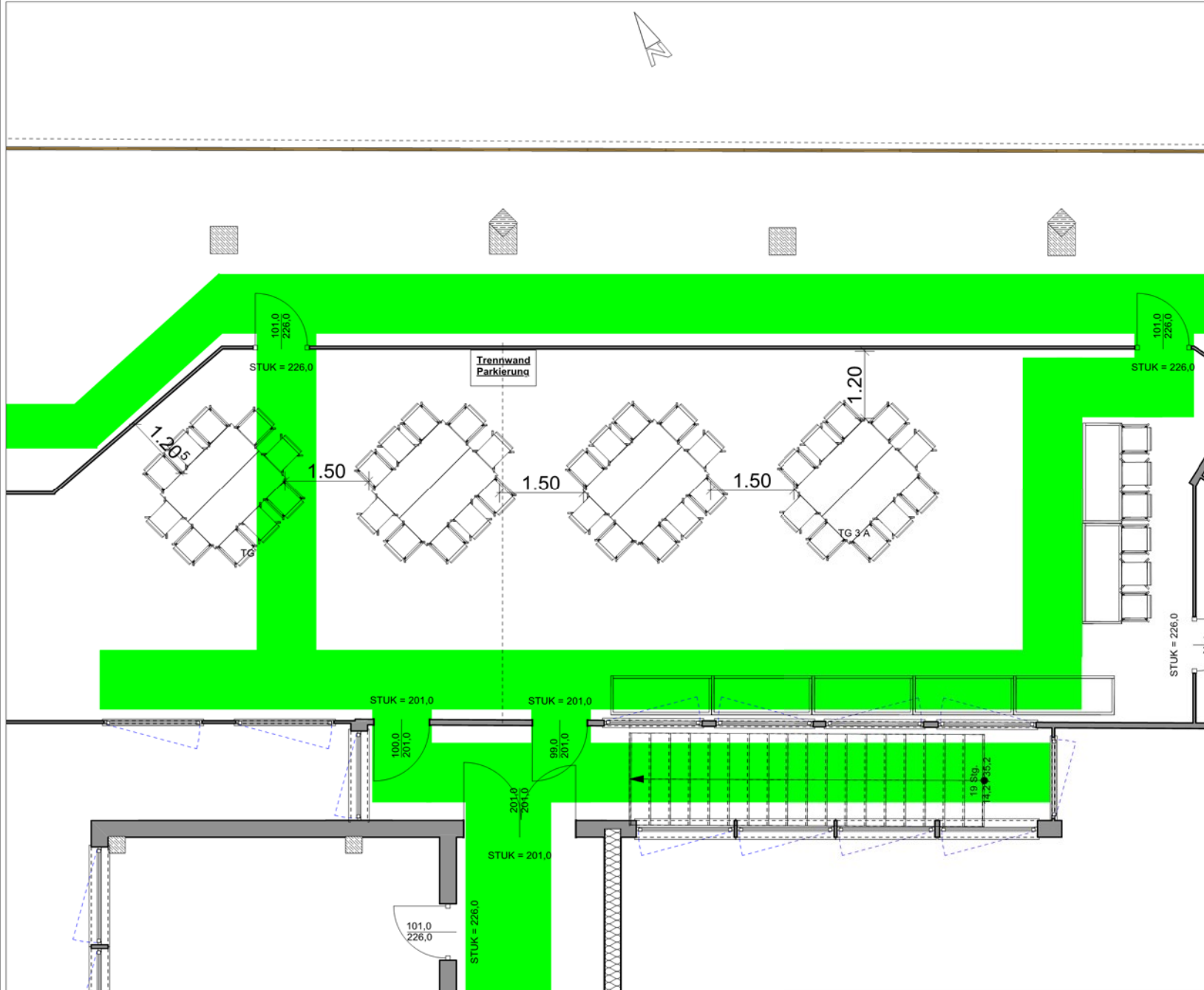

Milchwerk

RADOLFZELL

TAGUNG : KULTUR : MESSE

Raum **TG 3**

Carré
54 Pax
Zeichner: C.L.
Genehmigt:
Datum:

